

All materials supplied are in compliance with the requirements of the List of Prohibited Substances

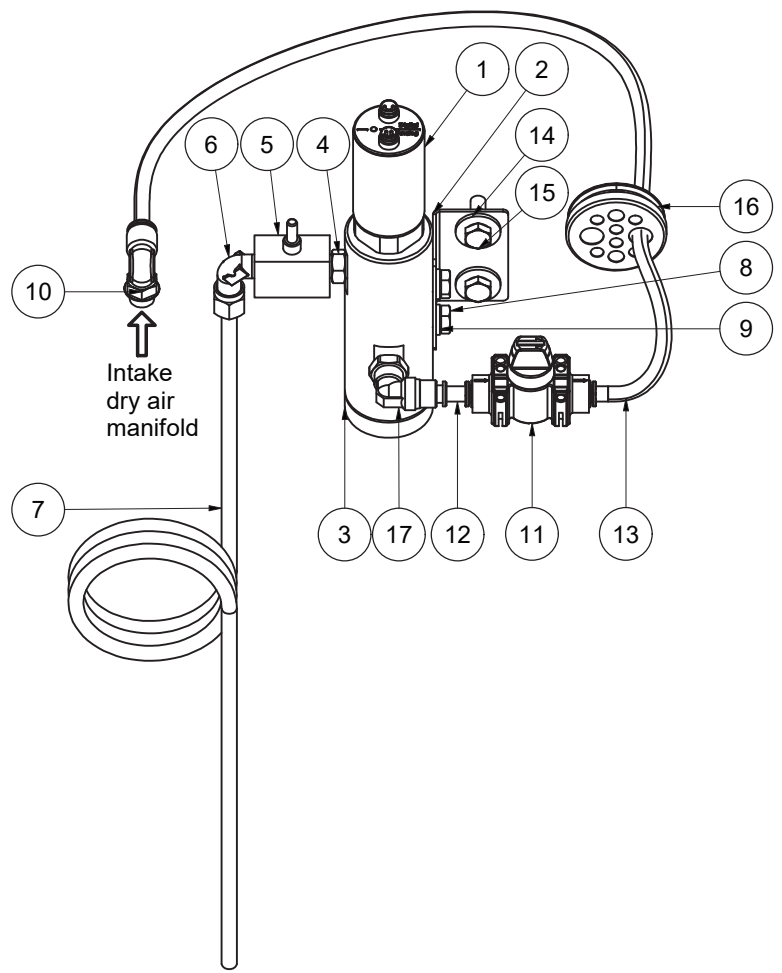

| Parts List | | | | | | |
|------------|-----|----------------|-----|-----------------|----------------|-----------------------------|
| Pos | Qty | Partnumber | R/S | Name | Material | Description |
| 1 | 1 | 1629230217-M1 | R | SENSOR DEWPOINT | Not applicable | TRANSMITTER |
| 2 | 1 | 1629220197-P1 | R | BRACKET | 0011 9034 94 | T= 1.25 |
| 3 | 1 | 1617965580 | R | HOUSING | Default | |
| 4 | 1 | 9740202111 | S | NIPPLE | SEE STANDARDS | |
| 5 | 1 | 8204094109 | R | VALVE | Default | |
| 6 | 1 | 0582200022 | R | ELBOW | 0011 5150 02 | |
| 7 | 1 | 1617947100 | R | TUBE | 0011 2333 02 | |
| 8 | 2 | 0147124203 | S | BOLT | SEE STANDARDS | |
| 9 | 2 | 0301232100 | S | WASHER PLAIN | See Standards | |
| 10 | 1 | 0583812073 | S | ELBOW 90 deg. | See Standards | |
| 11 | 1 | 0852001200 | S | VALVE BALL | See Standards | VALVE |
| 12 | 1 | 0070600238-M12 | | TUBE | See drawing | TUBE PDP-SENSOR |
| 13 | 1 | 0070600238-M13 | | TUBE | See drawing | TUBE MANIFOLD TO PDP-SENSOR |
| 14 | 2 | 0300 0274 64 | S | WASHER | SEE STANDARDS | |
| 15 | 2 | 0147195818 | S | SCREW | See Standards | |
| 16 | 1 | 0698015427 | S | GROMMET | See Standards | GROMMET |
| 17 | 1 | 0583812085 | S | COUPLING | See Standards | |
| 18 | 1 | 1629230204-P1 | | WIRING | See drawing | WIRING PDP CD25-260 |

| | | | | | | |
|---|--|-----------------|--|-------------------|--|--------------------------------------|
| Tolerances, if not indicated, according to: | | | | | | |
| STANDARD CLASS | | | | | | |
| Name | | INSTR. ASSEMBLY | | INSTR. PDP SENSOR | | Confidentiality Class acc. to 1102 K |
| Material | | See Drawing | | QCMD12-64 | | Confidential |
| Treatment | | Not Applicable | | INV | | |
| Scale | | 1 : 2 | | Family | | A3 Compare |
| Drawn by | | A00532653 | | Blank nr. | | Replaces |
| Version Drwg | | Blank wt | | Kg Fini wt. | | 0,369 kg |
| Des checked. | | Prod checked. | | Approved. | | Date 13/12/2022 |
| STATUS | | Released | | Designation | | 9827891705-01 |
| Ed | | Position | | Sheet | | 1 / 1 |

CONFIDENTIAL: This document is our property and shall not without our permission be altered, copied, used for manufacturing or communicated to any other person or company.

| | | | | | |
|----|----------|------------|-------------|-----------------|-----------------|
| 1 | | 14/12/2022 | User Agent | 1603709847-M1 | |
| Ed | Position | Date | Intr./Appd. | Parent 3D model | Ed . Version 3D |
| | | | | | |